

FACTORY CODE: 22023116000162

BZ33-INV18OUT2-J

.3586763

Optional function parts

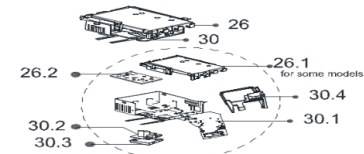
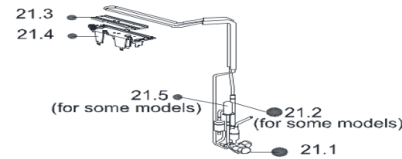
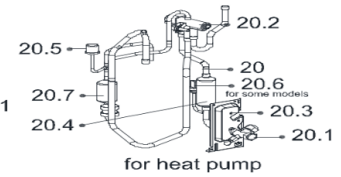
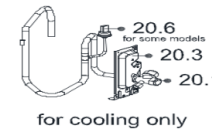
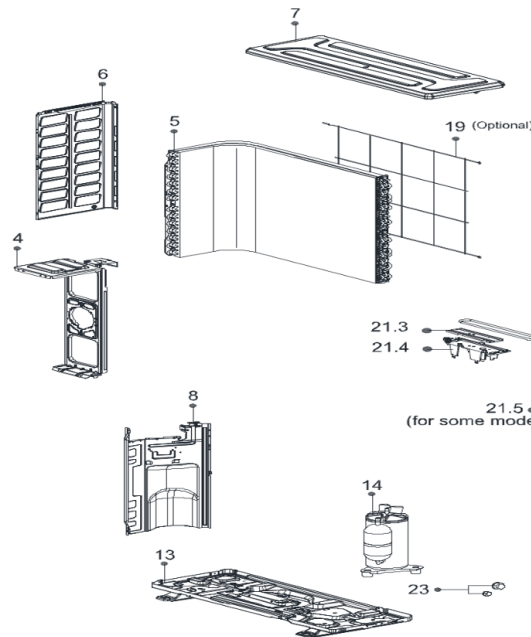
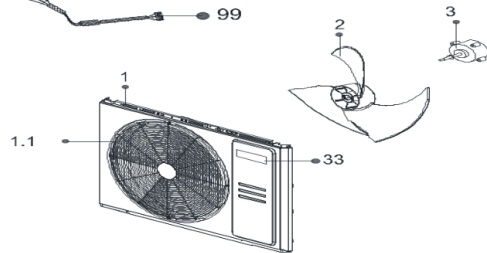
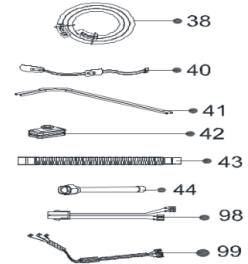

BZ33-INV18OUT2-J

.3586763

Part #	Replacement Part	Part Name	Qty
1	12222000A06282	Front panel assembly	1
1.1	12222000A06283	Front panel	1
2	12100105000841	Axial flow fan	1
3	11002015000366	Brushless DC motor	1
4	12222000012371	Motor bracket	1
5	15822000009796	Condenser assembly	1
6	12222000013472	Left supporter	1
7	12222000013465	Top cover assembly	1
8	12222000013245	Partition board assembly	1
9	12222000013466	Right clapboard assembly	1
10	12122000007150	Water collector	1
11	12222000010966	Big handle assembly	1
13	12222000014054	Chassis assembly	1
14	11103020004360	DC inverter rotary compressor	1
18	11201007000124	Pipe temperature sensor	1
19	12222000013085	Rear net	1
20	15422000021635	4-Way valve assembly	1
20.1	15500204000502	Gas valve	1
20.2	15500216000026	Four-way valve	1
20.3	12222200005738	Valve plate	1
20.4	15122000028801	Muffler subassembly	1
20.5	17400516000849	Pressure controller	1
20.6	11201008000773	Pressure sensor	1
20.7	15122000028753	Muffler subassembly	1
21	15422000025315	Liquid valve assembly	1
21.1	15500204000021	Gas valve	1
21.3	11203803001176	Radiator	1
21.4	12122000011478	U-typed support with copper pipe	1

Part #	Replacement Part	Part Name	Qty
21.5	15500213000176	Electronic expansion valve	1
23	15500406000003	Copper nut	1
23	15500406000010	Copper nut	1
24	11201011000188	Combination sensor	1
26	17222000043110	Electronic control box subassembly	1
26.1	12122000008999	Electronic installing box	1
26.2	17122000062650	Outdoor main control board subassembly	1
29	11201007003445	Pipe temperature sensor	1
30	17222000037856	Inverter module electronic control box subassembly	1
30.1	17222000031639	Terminal board subassembly	1
30.2	17122000062635	Inverter module subassembly	1
30.3	12122000029482	Electronic installing box	1
30.4	12122000029483	Cover of electronic control box subassembly	1
33	16022000C33643	Trademark	1
38	15111600A00285	Connecting flexible hose assembly	1
40	17402001000603	Crankcase electric heating strip	1
41	17402002000544	Heater	1
44	15123000012948	Evaporator connecting pipe subassembly	1
44	15123000013007	Evaporator connecting pipe subassembly	1
99	17401203012697	Compressor wires subassembly	1